

Safety Information

① General Safety

- The use and operation of this product, including the handling and disposal of any emissions generated during engraving processes, must comply with all applicable laws and regulations in your country or region.
- Always operate and maintain the product according to this manual's instructions to ensure safe operation.
- DO NOT allow use by minors, by untrained personnel, or by any personnel suffering from any physical or mental limitation that might affect their ability to use the machine safely and properly.
- Place the product on a stable and level work surface.
- Keep the area around the machine dry, well ventilated, and environmentally controlled to 10-35°C (50-95°F) and 10-85% humidity.
- Do NOT leave the machine unattended during operation.

Immediately stop operation and disconnect power if any of the following occurs:

- A burning smell is detected coming from the machine.
- Open flames or sparks are observed being generated from the engraving material.
- Any components of the machine appear to be damaged or malfunctioning.
- Unexpected cessation of machine operation for no clear reason.
- Abnormal sounds, smoke, or unusual lighting are emitted from the machine.

② Laser Safety

- The LPI Plus laser engraving machine is initially classified as a Class 4 laser device.
- The active laser and its reflections can rapidly cause fires, burns, and permanent vision damage. Under normal circumstances, the laser is blocked by the protective cover during operation. Before using the machine, ensure that the protective cover is installed properly.
- Before operating the device, users should fully understand the physical characteristics of laser radiation, its hazard classifications, related health effects, and the necessary safety precautions.
- When operating the device, avoid direct skin contact with the laser to prevent potential burns or other injuries.
- During operation, the materials being engraved or cut may release toxic and harmful gases or fumes. Depending on the type and composition of the engraving/cutting materials, these emissions can pose health and environmental risks. To ensure safe use, it is recommended to use this machine with an air purifier to effectively absorb and filter any toxic or harmful gases generated.
- DO NOT use this laser in dewy, dusty, or high-EMI conditions where the active laser might easily be deflected or reflected.
- Only use the machine with stable and compatible power sources. This machine requires a 5V/5A power adapter. Failure to use the compatible power adapter can result in machine malfunction.
- Before starting the device for engraving, ensure that all safety precautions are in place. Wear protective goggles to prevent accidental laser injury to the eyes or skin. Remove unrelated items to avoid unnecessary damage from laser exposure. In particular, remove any flammable or explosive materials to prevent the risk of fire.

③ Emergency Procedures

- In case of fire during engraving:
 - Cut off the power supply immediately.
 - Use a fire extinguisher to put out the flames.
- Smoke and Particulate Matter Exposure:
 - Engraving or cutting certain materials may generate smoke and particles that can irritate the respiratory system. Use the product with an air purifier or in a well-ventilated area. Wear a protective mask when necessary.
 - If someone experiences respiratory irritation or similar symptoms, immediately move them to fresh air and seek medical attention.

④ Safety Labels

The warning and instruction signs are labeled where physical injuries or damage to the machine may be caused before and/or during operation. If a sign is damaged or lost, replace it immediately. You can use the following template to print the sign you need.



LDS App Download

Scan the QR code below to download and install the LaserPecker Design Space App.
Note: After downloading and installing the app, please be sure to read the warnings and precautions within the App carefully.



LaserPecker Design Space

Getting Help

Technical Support

If you encounter any issues, please do not hesitate to reach out to our customer support team at support@laserpecker.com

- YouTube: @LaserPecker
- Facebook Group: LaserPecker LPI Official Group

Video Tutorials

Scan the QR code below to learn how to use LaserPecker machines.



Package List

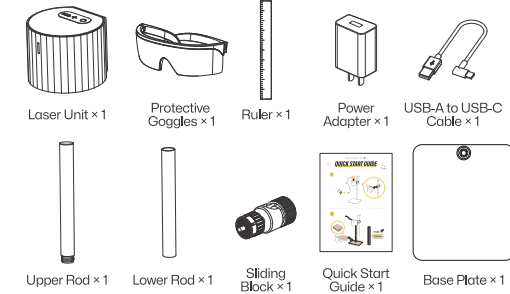

Component Introduction

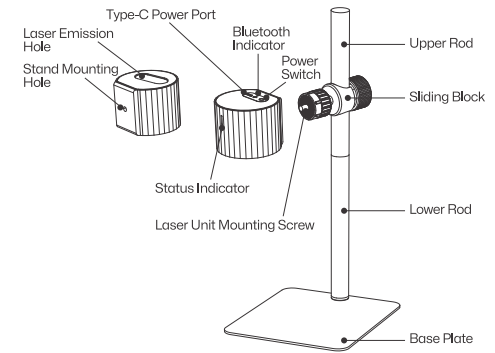

Quick Assembly

Stand Installation

Twist the Upper Rod and Lower Rod together to assemble one long rod. Secure the rod into the Base Plate. Then slide the Sliding Block onto the rod and secure it in place.

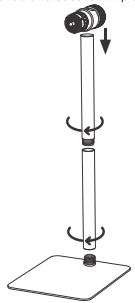

Laser Unit Installation

Rotate the Laser Unit clockwise onto the Sliding Block. Level the unit, then tighten the arm's ball head to secure it in place.

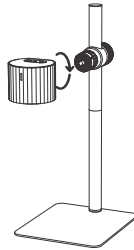

Power Connection

Use any Type-C power source with at least 5V/2A output. The included charger is recommended for best performance, but any QC2.0-certified charger will also work (see below).

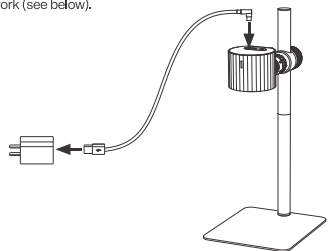

Using the Product

Focusing

Slide the Sliding Block to adjust the height so that the distance between the laser lens and the surface is exactly 200 mm. Use the included ruler for accuracy.

Note: If the distance is incorrect, the engraving may be uneven or leave no mark.

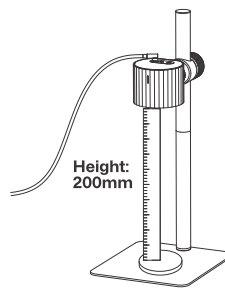

Power Switch

Press and hold to STOP all operations. A quick press will PAUSE the job.

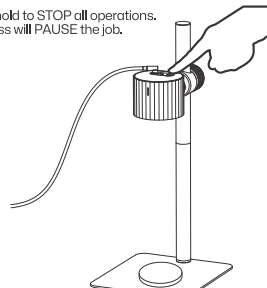

Connect to LDS APP

Connect via Bluetooth

Open the LaserPecker Design Space App, tap the "+" at the top-right corner, and select LPI Plus from the device list. Then tap your device to connect. Once connected, the indicator light will stay solid blue.

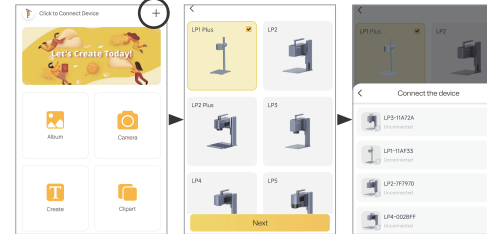

Technical Specifications

Dimensions	Laser Unit: 65 × 61 × 53 mm	Stand: 140 × 160 × 320 mm
Net Weight	Laser Unit: 0.21 kg	Total Weight: 0.72 kg
Laser Source & Power	405 nm Diode Laser, 600 mW	
Working Area	100 × 100 mm	
Appearance	ABS+PC, Aluminum Alloy	
Preview Modes	Rectangular Preview / Vector Preview / Center Point Preview	
Supported File Formats	G-code / JPG / PNG / SVG	
Connection Method	Bluetooth	
Supported OS	iOS 13.0+, Android 7.0+	
Input Power	Type-C (5V, 2A)	
Environment	Temperature: 10-35 °C Humidity: 10-95 % RH (non-condensing)	
Cooling System	Natural Cooling	
Certifications	CE / RoHS / FCC / FDA / PSE / MIC / UKCA / GB 4943.1	

Statements

Disclaimer

Thank you for choosing LaserPecker! This manual relates to your safety, legal responsibilities and rights. Please read and get familiar with all safety precautions and procedures before using the product. If you do not use the product according to the instructions and requirements of the manual, or mis-operate the product due to misunderstanding, etc., LaserPecker (Hingin Technology Co., Ltd.) shall bear no responsibility for any loss resulting therefrom.

- Given the conditions and methods of use of this product are beyond the control of LaserPecker, LaserPecker shall not be liable for any of the following consequences, which shall be borne by the user:
 - Personal injury, property loss, and product damage caused by improper operation, failure to follow the manual or other uncertainties.
 - The work that user created using the LaserPecker product infringes intellectual property rights of the third party or violates relevant laws and regulations.
 - Personal injury, property loss, and product damage that may arise during the installation, transportation, storage, use, maintenance, and disposal of this product.
 - All official LaserPecker materials have undergone safety testing and are compatible with this product. LaserPecker shall not be liable for material safety or engraving quality if the user uses non-LaserPecker official materials.

Copyright

- Copyright of this manual, as well as the rights to the software and hardware related to this product, are owned by Shenzhen Hingin Technology Co., Ltd. (hereinafter referred to as "Hingin Technology"). LaserPecker is a registered trademark of Hingin Technology.
- The information in this manual may be changed without notice; The information in this manual does not constitute a commitment of the Company. Please learn about the latest update from (<https://www.laserpecker.net>). The contents of this manual shall not be rewritten or forwarded in any form or for any purpose without the written permission of the Company.