

LPI Plus

(Creator / Deluxe)

User Manual

v1.0

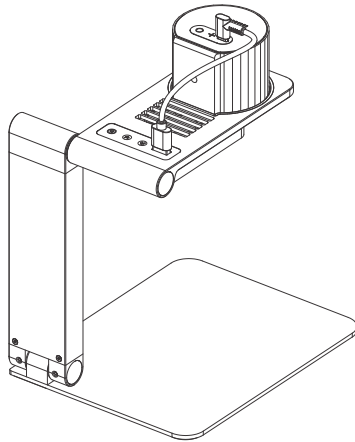

Quick Assembly

1. Install the Laser Unit and Auto-Focus Stand

Unfold the Auto-Focus Stand as shown, Align the Laser Unit with the mounting slots on the stand and place it securely in position.

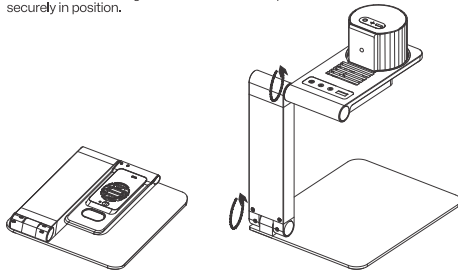

2. Cable Connection

① Connect the USB-C end of the included 0.2 m cable to the Laser Unit, and the USB-A end to the upper port on the Auto-Focus Stand.

② Prepare a 5V/2A or higher power adapter, and use the included 1m cable to connect the power adapter to the lower port on the Auto-Focus Stand. (A power adapter, power bank, or charger certified for QC 2.0 or above is recommended.)

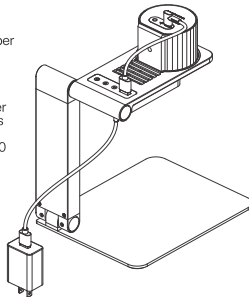

Safety Information

① General Safety

- The use and operation of this product, including the handling and disposal of any emissions generated during engraving processes, must comply with all applicable laws and regulations in your country or region.
- Always operate and maintain the product according to this manual's instructions to ensure safe operation.
- DO NOT allow use by minors, by untrained personnel, or by any personnel suffering from any physical or mental limitation that might affect their ability to use the machine safely and properly.
- Place the product on a stable and level work surface.
- Keep the area around the machine dry, well ventilated, and environmentally controlled to 10-35°C (50-95°F) and 10-95% humidity.
- Do NOT leave the machine unattended during operation.
- If you notice a burning smell, abnormal smoke or flames, damaged components, unexpected shutdown, or unusual noise or light, stop using the device immediately and disconnect the power.

② Laser Safety

- The LPI Plus is a Class 4 laser device. Laser radiation may cause fire, burns, or permanent eye injury. With Protective Panels: Proper assembly and full enclosure of the processing area are required. Without Protective Panels: Certified laser safety goggles and appropriate skin protection are required. Never look directly at the laser beam or its reflections.
- Before operating the device, familiarize yourself with laser-related risks and take all necessary safety precautions. Do not allow direct skin exposure to the laser during operation.
- Engraving or cutting certain materials may generate toxic or hazardous gases or fumes. Operate the device in a well-ventilated area and use an air purifier when necessary to reduce health and environmental risks.
- Do not use the device in humid, dusty environments or areas with strong electromagnetic interference.
- Before starting engraving, remove unnecessary objects and all flammable or explosive materials from the work area to prevent damage or fire caused by laser exposure.
- Use only a 5 V/2 A power adapter to ensure proper and safe operation.

③ Emergency Procedures

- If open flames occur during engraving, immediately disconnect the power and use a fire extinguisher to extinguish the fire.
- Engraving or cutting certain materials may generate irritating fumes and particles. Wear a protective mask if necessary. If respiratory discomfort occurs, move to an area with fresh air immediately and seek medical attention.

④ Safety Labels

When operating the device, ensure that clear and intact safety warning labels are placed at all hazardous locations. If any label is damaged or missing, replace it promptly. You may refer to the templates below to print the required labels.



Button Overview

① Power Switch

Long press: Stop operation
Short press: Pause operation

② Auto-Focus Stand Buttons

Power / Auto Focus Button
Long press: Power on/off
Short press: Start auto focus

Up / Down Buttons
Short press: Move up/down by 1mm
Long press: Continuous upward/downward

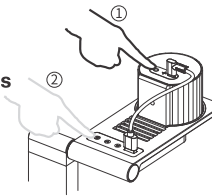

Using the Product

The optimal engraving focus distance for the LPI Plus is 200mm, measured from the laser lens to the surface of the material.

Auto Focus

Press the Auto Focus button. The Auto-Focus Stand will automatically adjust the focus distance to 200mm.

★ To ensure the reliability of the auto-focus function, it is recommended to use the included **Focus Card** during focusing. Place it flat against the material surface to help the TOF sensor measure distance accurately.

Manual Focus

Use the included ruler to measure the distance from the laser lens to the material surface. Adjust the height using the Up/Down buttons on the Auto-Focus Stand until the optimal focus distance is reached.

Using Protective Panels

When the machine is equipped with Protective Panels, assemble them properly before engraving to enclose the Stand and the Laser Unit, in order to contain the laser and ensure safe operation.

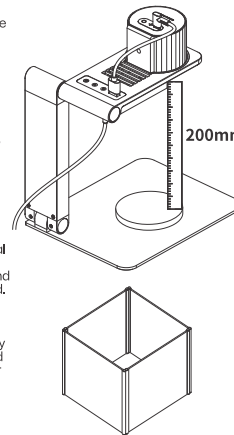

LDS App Download

Scan the QR code below to download and install the LaserPecker Design Space App. **Note:** After downloading and installing the app, please be sure to read the warnings and precautions within the App carefully.



LaserPecker Design Space

Getting Help

Technical Support

If you encounter any issues, please do not hesitate to reach out to our customer support team at support@laserpecker.com

YouTube: @LaserPecker

Facebook Group: LaserPecker LPI Official Group

Video Tutorials

Scan the QR code below to learn how to use LaserPecker machines.



Package List

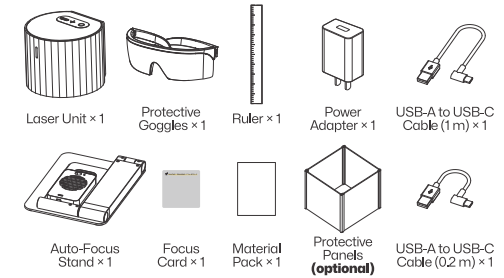

Component Introduction

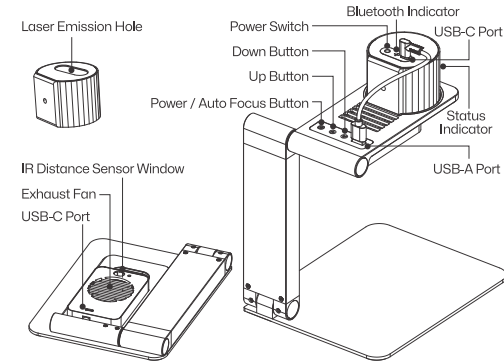

Quick Assembly

1. Install the Laser Unit and Auto-Focus Stand

Unfold the Auto-Focus Stand as shown, Align the Laser Unit with the mounting slots on the stand and place it securely in position.

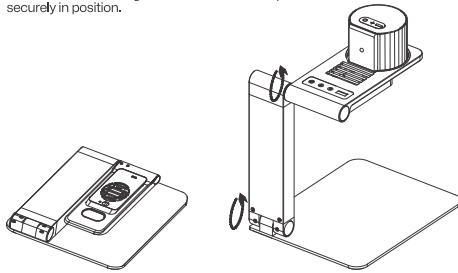

2. Cable Connection

① Connect the USB-C end of the included 0.2 m cable to the Laser Unit, and the USB-A end to the upper port on the Auto-Focus Stand.

② Prepare a 5V/2A or higher power adapter, and use the included 1m cable to connect the power adapter to the lower port on the Auto-Focus Stand. (A power adapter, power bank, or charger certified for QC 2.0 or above is recommended.)

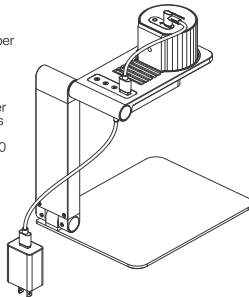

Button Overview

① Power Switch

Long press: Stop operation
Short press: Pause operation

② Auto-Focus Stand Buttons

Power / Auto Focus Button
Long press: Power on/off
Short press: Start auto focus

Up / Down Buttons
Short press: Move up/down by 1mm
Long press: Continuous upward/downward

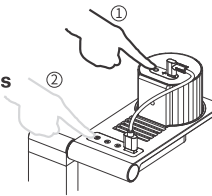

Using the Product

The optimal engraving focus distance for the LPI Plus is 200mm, measured from the laser lens to the surface of the material.

Auto Focus

Press the Auto Focus button. The Auto-Focus Stand will automatically adjust the focus distance to 200mm.

★ To ensure the reliability of the auto-focus function, it is recommended to use the included **Focus Card** during focusing. Place it flat against the material surface to help the TOF sensor measure distance accurately.

Manual Focus

Use the included ruler to measure the distance from the laser lens to the material surface. Adjust the height using the Up/Down buttons on the Auto-Focus Stand until the optimal focus distance is reached.

Using Protective Panels

When the machine is equipped with Protective Panels, assemble them properly before engraving to enclose the Stand and the Laser Unit, in order to contain the laser and ensure safe operation.

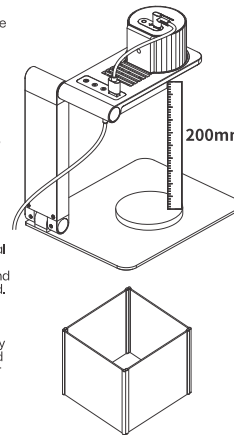

Connect to LDS APP

Connect via Bluetooth

Open the LaserPecker Design Space App, tap the "H" at the top-right corner, and select LPI Plus from the device list. Then tap your device to connect. Once connected, the indicator light will stay solid blue.

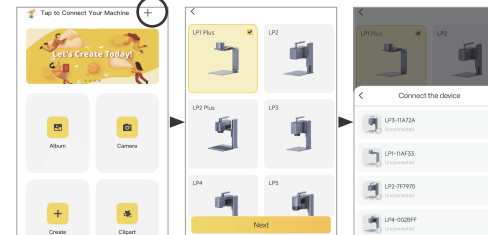

Technical Specifications

Dimensions	Laser Unit: 65 × 61 × 53 mm	Stand: 194 × 153 × 25 mm
Net Weight	Laser Unit: 0.21 kg	Stand: 0.84 kg
Laser Source & Power	405 nm Diode Laser, 600 mW	
Working Area	100 × 100 mm	
Appearance	ABS+PC, Aluminum Alloy	
Preview Modes	Rectangular / Vector / Center Point	
Supported File Formats	G-code / JPG / PNG / SVG	
Connection Method	Bluetooth	
Supported OS	iOS 13.0+, Android 7.0+	
Input Power	Type-C (5 V, 2 A)	
Environment	Temperature: 10-35 °C Humidity: 10-95% RH (non-condensing)	
Cooling System	Natural Cooling	
Certifications	CE / RoHS / FCC / FDA / PSE / MIC / UKCA / GB 4943.1	

Statements

Disclaimer

Thank you for choosing LaserPecker! This manual relates to your safety, legal responsibilities and rights. Please read and get familiar with all safety precautions and procedures before using the product. If you do not use the product according to the instructions and requirements of the manual, or mis-operate the product due to misunderstanding, etc., LaserPecker (Hingin Technology Co., Ltd.) shall bear no responsibility for any loss resulting therefrom.

- Given the conditions and methods of use of this product are beyond the control of LaserPecker, LaserPecker shall not be liable for any of the following consequences, which shall be borne by the user:
 - Personal injury, property loss, and product damage caused by improper operation, failure to follow the manual or other uncertainties.
 - The work that user created using the LaserPecker product infringes intellectual property rights of the third party or violates relevant laws and regulations.
 - Personal injury, property loss, and product damage that may arise during the installation, transportation, storage, use, maintenance, and disposal of this product.
 - All official LaserPecker materials have undergone safety testing and are compatible with this product. LaserPecker shall not be liable for material safety or engraving quality if the user uses non-LaserPecker official materials.

Copyright

- Copyright of this manual, as well as the rights to the software and hardware related to this product, are owned by Shenzhen Hingin Technology Co., Ltd. (hereinafter referred to as "Hingin Technology"). LaserPecker is a registered trademark of Hingin Technology.
- The information in this manual may be changed without notice; The information in this manual does not constitute a commitment of the Company. Please learn about the latest update from (<https://www.laserpecker.net>). The contents of this manual shall not be rewritten or forwarded in any form or for any purpose without the written permission of the Company.