

# Rotary Extension

User Manual | Bedienungsanleitung  
Manual de Usuario | Manuel d'utilisation

# Contents

---

Contents	01
Package List	02
Component Overview	03
Quick Assembly	04
Using the Product	07
LP2 Plus with Rotary Extension	09
LP4 with Rotary Extension	10
LP5 with Rotary Extension	11
LX2 with Rotary Extension	12
Using with LDS Software & App	13
Getting Help	13
Technical Specifications	14
Statements	14

# Package List

---



M3\*6 Screw × 6 (For Jaws)  
M3\*10 Screw × 4  
(For Headstock & Base Plate)

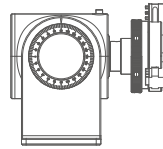

Rotary Headstock × 1

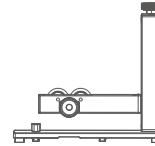

Tailstock × 1



Base Plate × 1

---

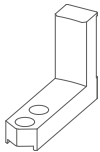

Single-Step Jaw × 3

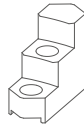

Double-Step Jaw × 3



Stud × 3



Elevation Pad × 1  
(LX2 No Elevation Pad Included)

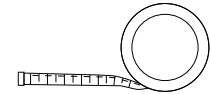

Measuring Tape × 1

---

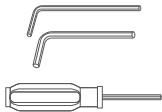

Hex Key H2 × 1  
Hex Key H2.5 × 1  
Hex Screwdriver H3.0 × 1

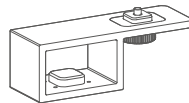

Riser × 1 (Optional)

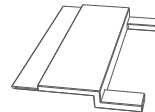

Positioning Block × 1 (Optional)

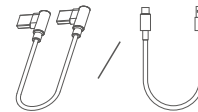

USB Cable × 1



User Manual × 1

# Component Overview

---

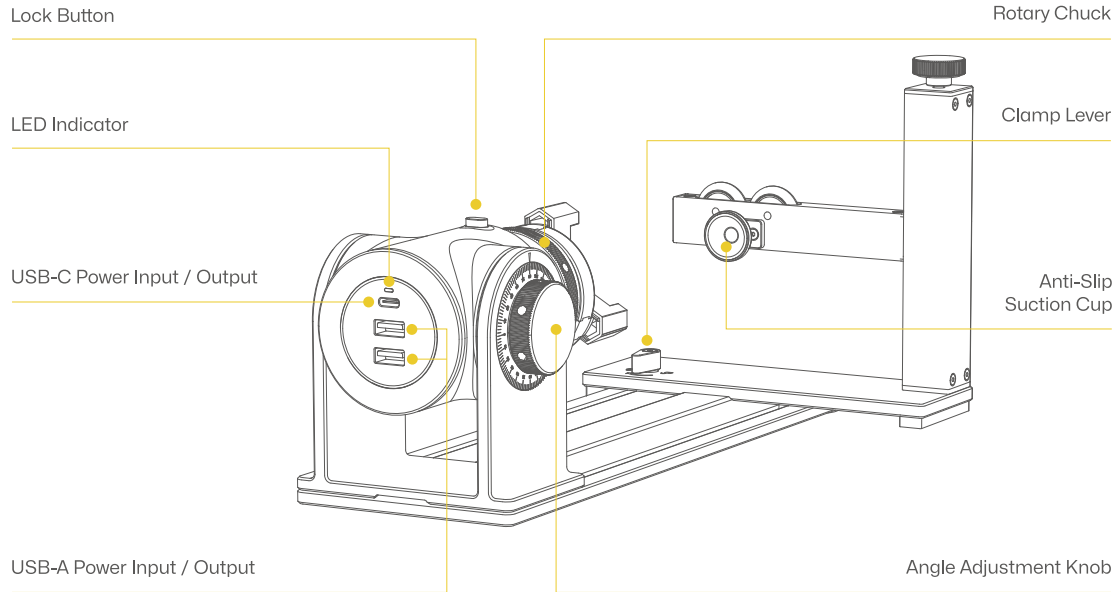

## Quick Assembly

### Rotary Headstock Installation

Secure the Rotary Headstock to the Base Plate with four M3\*10 screws, then tighten them with the H2 hex key.

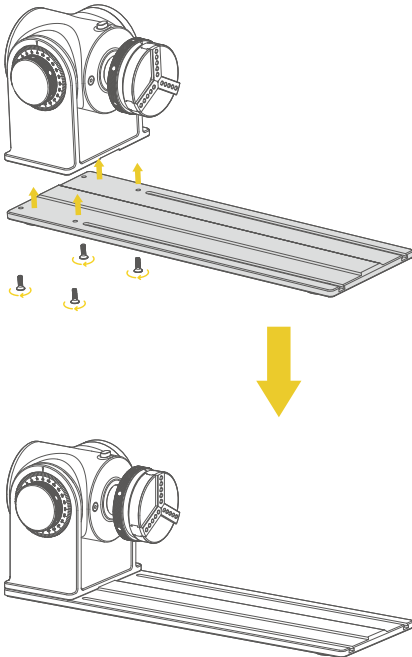

### Double-Step Jaws Installation (Material Diameter Range: 1mm-128mm)

Secure the three Double-Step Jaws to the Rotary Chuck with six M3\*6 screws, then tighten them with the H2.5 hex key.

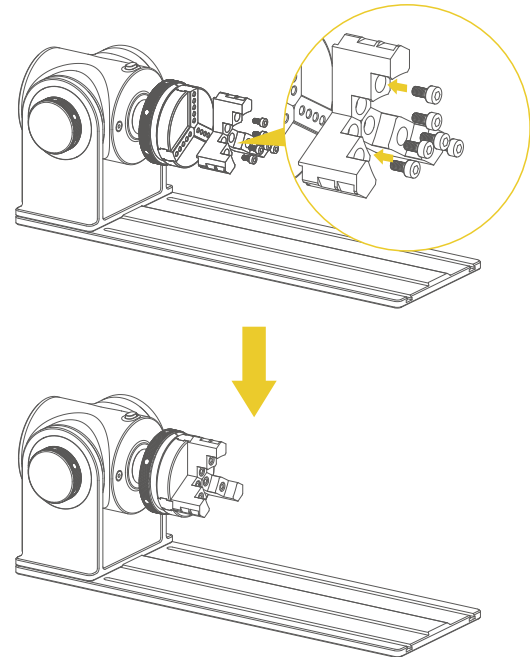

## Quick Assembly

### Single-Step Jaws Installation (Material Diameter Range: 66mm-145mm)

Secure the three Single-Step Jaws to the Rotary Chuck with six M3\*6 screws, then tighten them with the H2.5 hex key.

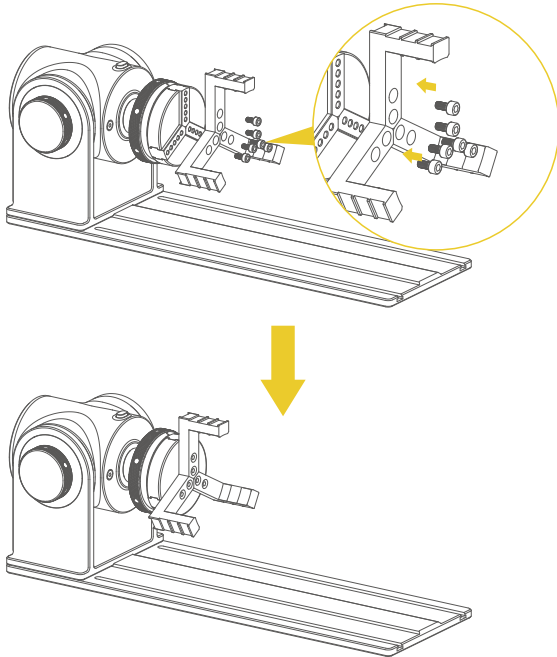

### Stud Installation (Material Diameter Range: 13mm-78mm)

Confirm the material's diameter. Then insert the three studs into the corresponding holes in the Rotary Chuck.

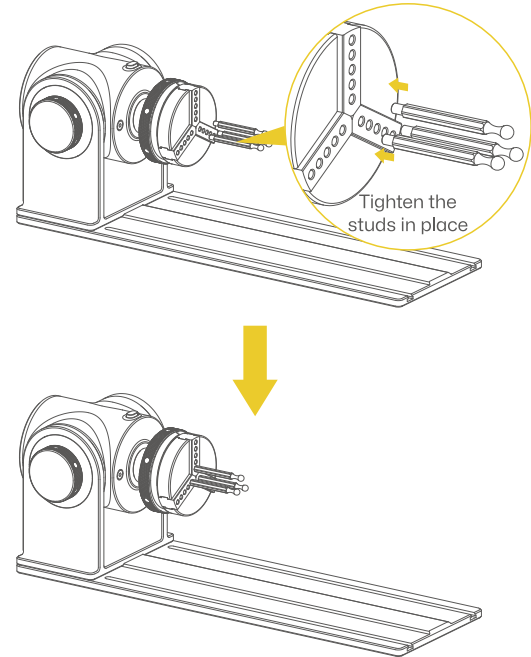

# Quick Assembly

## Tailstock Installation

1. Slide the Tailstock onto the track of the Base Plate.

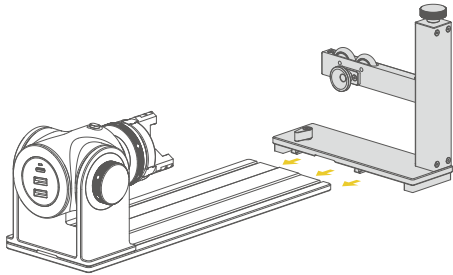

2. The Tailstock supports cylindrical objects mounted on the rotary chuck. Once it is positioned for the material being used, turn the Clamp Lever to lock it in place.

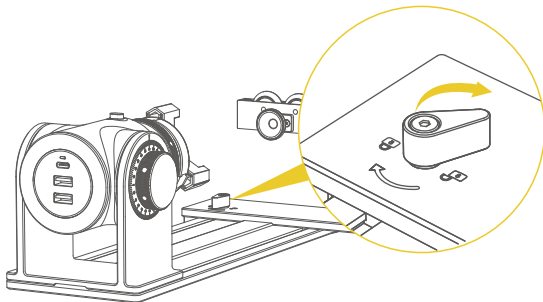

## Rotary Extension Leveling

Place the Elevation Pad under the Rotary Headstock to level it with the Machine Base Plate. Use only if needed.

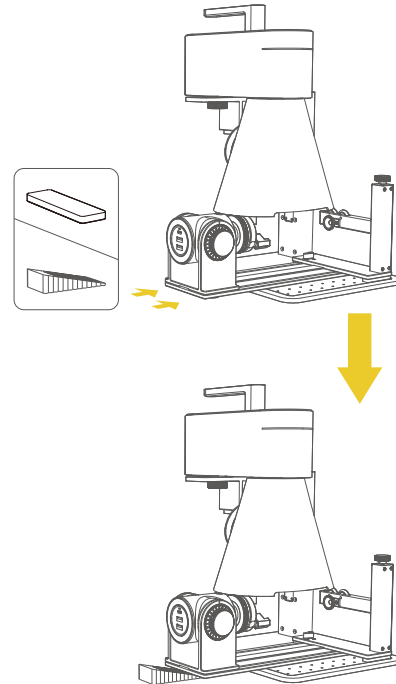

# Using the Product

## Rotary Chuck Adjustment

1. Align the white mark on the rotary shaft with the arrow on the Rotary Extension Motor, and press the Lock Button to secure the Rotary Chuck in place, preventing accidental rotation of the rotary head.

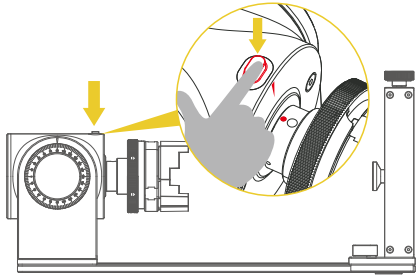

2. To accommodate larger diameter materials, rotate the chuck counterclockwise to open the jaws.

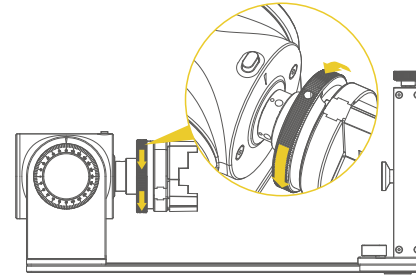

3. Once the jaws clamp the material, use an H3.0 hex screwdriver to tighten the chuck clockwise.

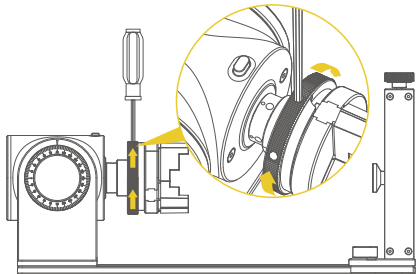

4. After the material is secured, press the Lock Button again to unlock. Otherwise, the Rotary Extension will not rotate properly during preview.

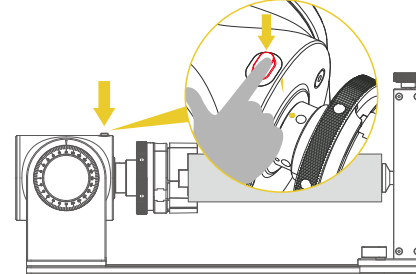

# Using the Product

## Engraving Angle Adjustments

1. Rotate the Angle Adjustment Knob counterclockwise to adjust the angle of the Rotary Headstock. This allows you to align the engraving surface of the material so that it remains parallel to the Base Plate.

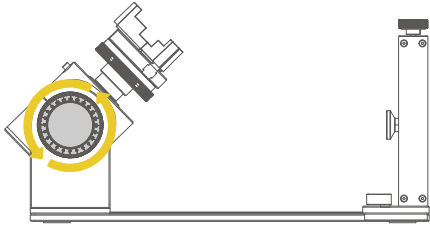

2. Once the desired angle is set, use an H3.0 hex screwdriver to tighten the Angle Adjustment Knob clockwise, locking the Rotary Headstock in position.

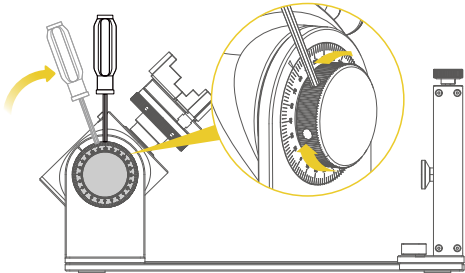

## Tailstock Usage

- Rotate the top knob of the Tailstock clockwise to raise it, or counterclockwise to lower it. Adjust the Tailstock to the appropriate height to support the engraving material and keep it level.

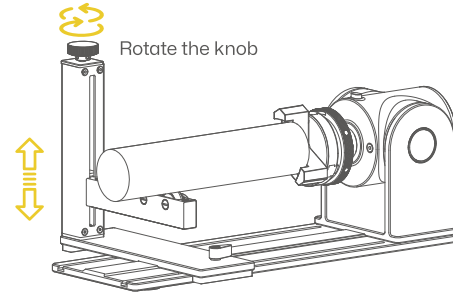

## LP2 Plus with Rotary Extension

USB-A Port (Connect to Electric Stand)

USB-A Port (Connect to Conical Protective Cover)

DC Power Port

USB-A Port (Connect to Rotary Extension)

USB-C Port  
(Electric Stand Power Input)

USB-C Port  
(Rotary Extension Power Input)

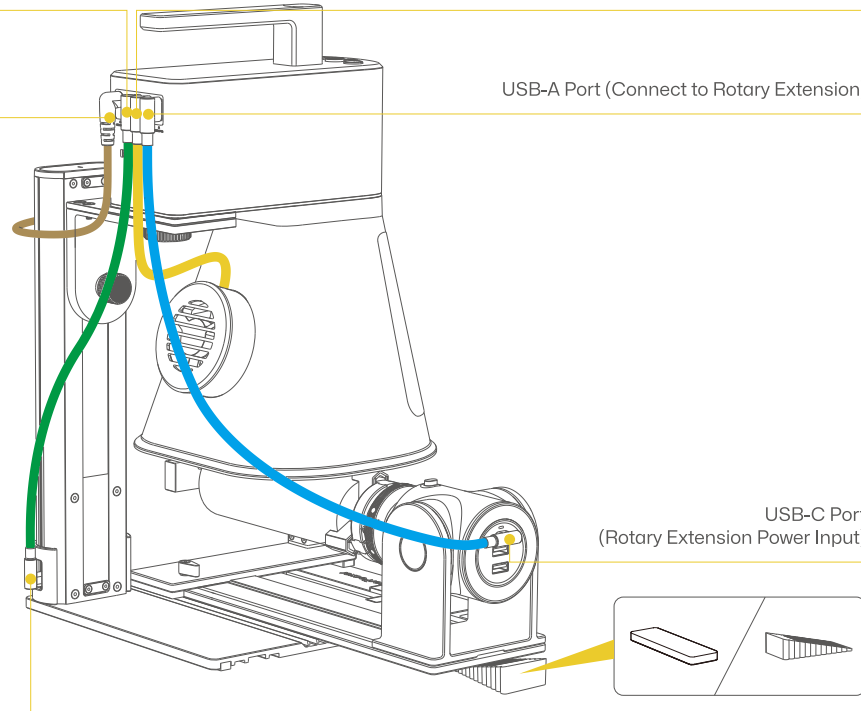

## LP4 with Rotary Extension

Install the Riser between the LP4 Laser Unit and Electric Stand to use the Rotary Extension, then tighten the two knobs to secure it in place.

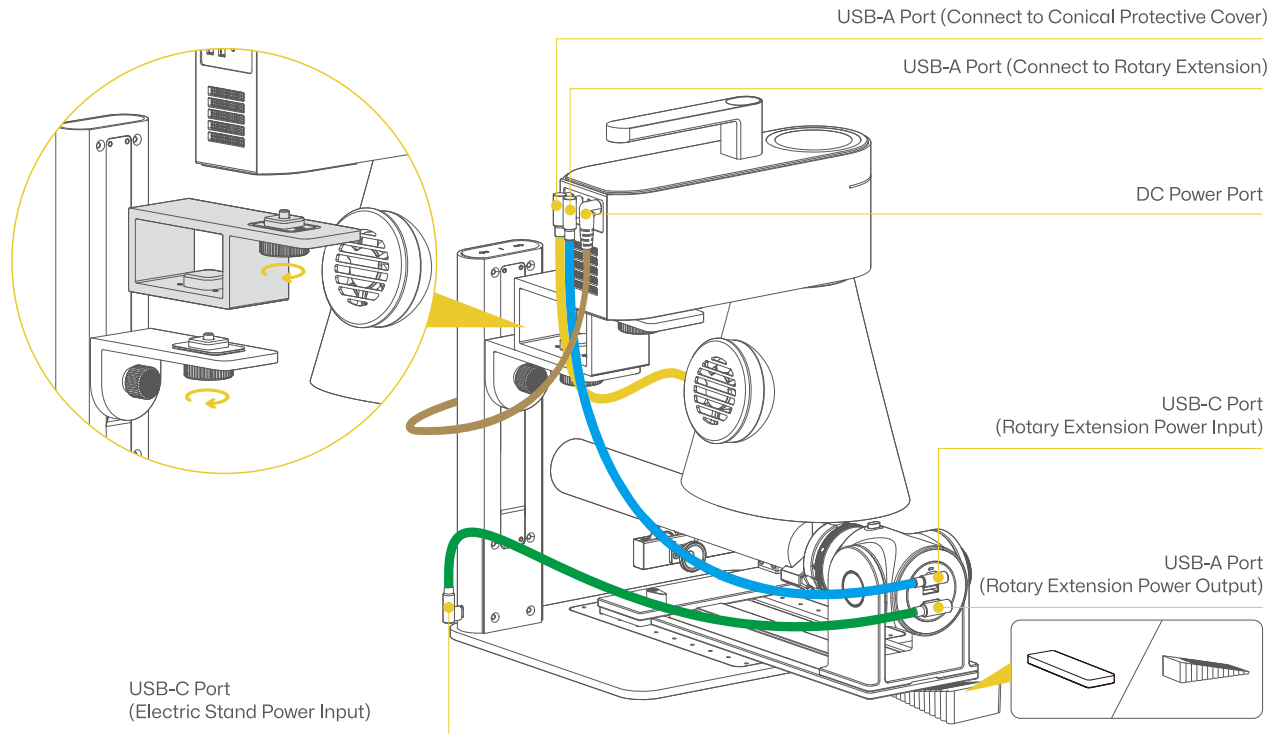

## LP5 with Rotary Extension

---

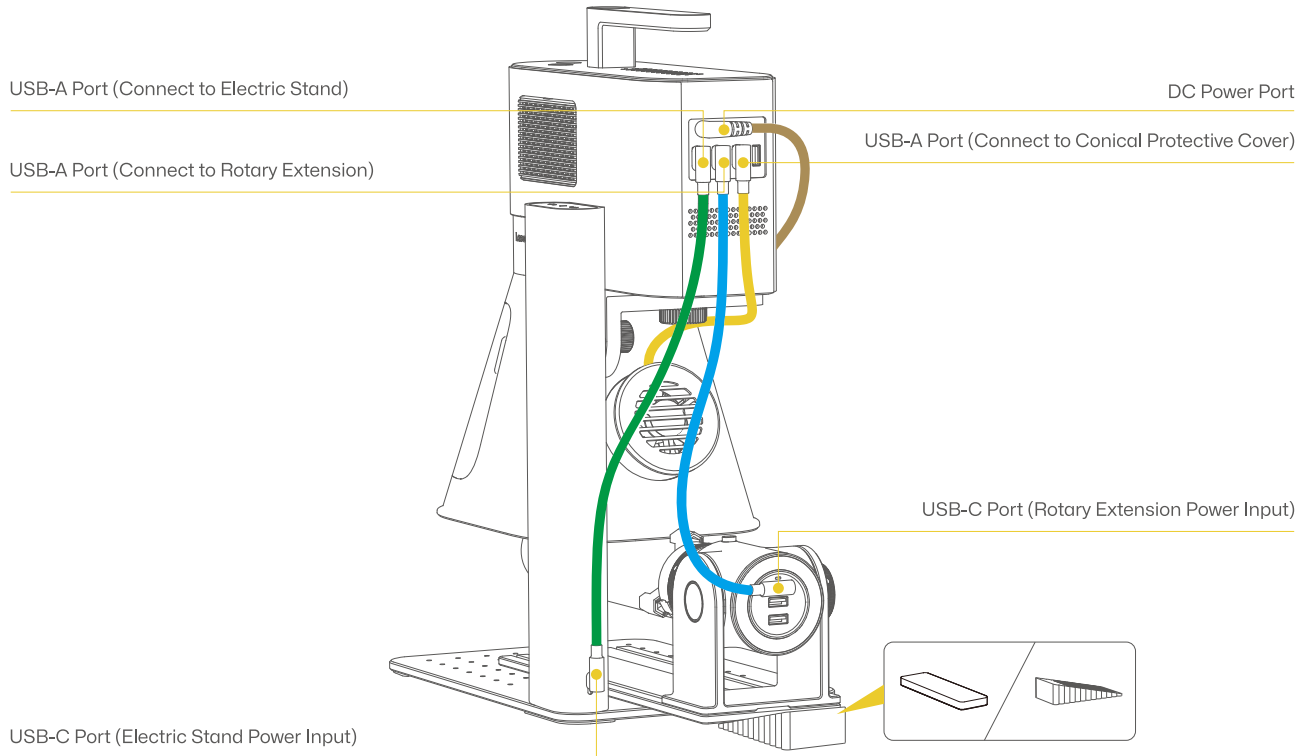

## LX2 with Rotary Extension

The LX2 must be installed on a Riser Base (sold separately) before using the Rotary Extension.

1. Place the LX2 Base Plate into the appropriate layer of the Riser Base according to the height of the object to be engraved, then insert the Positioning Block into the locating hole.

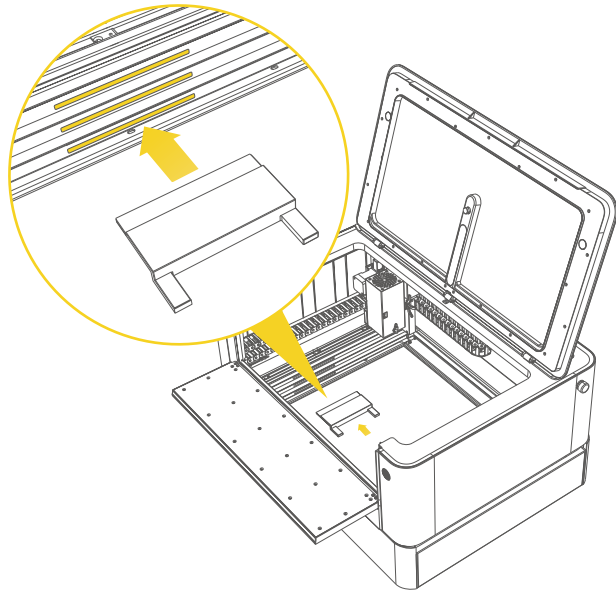

2. Connect one end of the USB-A to USB-A cable to the Rotary Extension and the other end to LX2, then put the Rotary Extension into the Positioning Block.

USB-A Port (Rotary Extension Power Input)

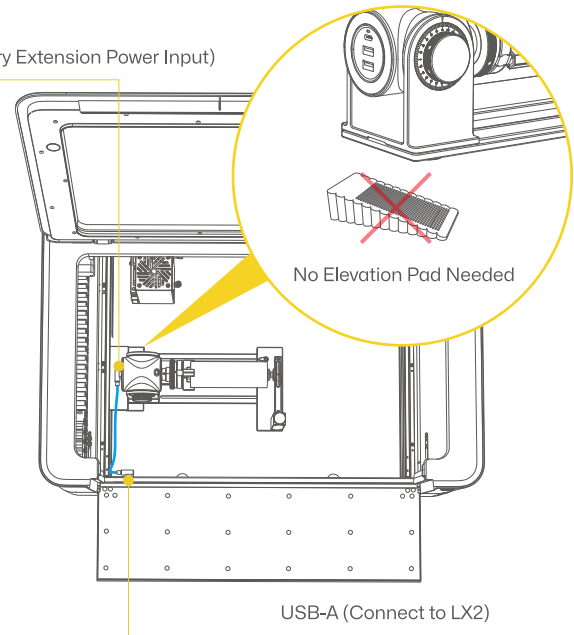

## Using with LDS Software & App

---

After connecting the Rotary Extension to the Laser Machine, open the LaserPecker Design Space App or software, and enable Rotary Extension Mode in the mode settings.

- 1 Tap the settings icon (top right).

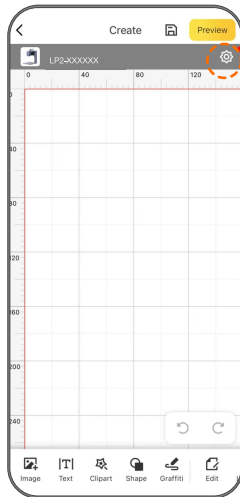

- 2 Enable "Rotary Extension".

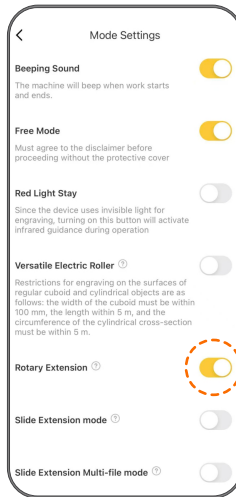

## Getting Help

---

### Technical Support

If you encounter any issues, please do not hesitate to reach out to our customer support team at [support@laserpecker.com](mailto:support@laserpecker.com)

### Video Tutorial

Scan the QR code below to learn how to use the Rotary Extension.



## Technical Specifications

Size	308 × 108 × 99 mm
Weight	1.7 kg
Exterior Material	Aluminum Alloy
Maximum Engraving Diameter	200 mm
Engraving Diameter Range	Single-Step Jaw: 66 mm - 145 mm
	Double-step Jaw: 1 mm - 128 mm
	Stud Component: 13 mm - 78 mm
Power Input	5V/1A
Angle Precision	0.014°
Idling Movement Speed	140.625°/s
Maximum Engraving Speed	117.1875°/s
Minimum Engraving Speed	11.25°/s

## Statements

### Disclaimer

Thank you for choosing LaserPecker! This manual relates to your safety, legal responsibilities and rights. Please read and get familiar with all safety precautions and procedures before using the product. If you do not use the product according to the instructions and requirements of the manual, or mis-operate the product due to misunderstanding, etc., LaserPecker (Hingin Technology Co., Ltd.) shall bear no responsibility for any loss resulting therefrom.

Given the conditions and methods of use of this product are beyond the control of LaserPecker, LaserPecker shall not be liable for any of the following consequences, which shall be borne by the user:

- Personal injury, property loss, and product damage caused by improper operation, failure to follow the manual or other uncertainties.
- The work that user created using the LaserPecker product infringes intellectual property rights of the third party or violates relevant laws and regulations.
- Personal injury, property loss, and product damage that may arise during the installation, transportation, storage, use, maintenance, and disposal of this product.
- All official LaserPecker materials have undergone safety testing and are compatible with this product. LaserPecker shall not be liable for material safety or engraving quality if the user uses non-LaserPecker official materials.

### Copyright

- Copyright of this manual, as well as the rights to the software and hardware related to this product, are owned by Shenzhen Hingin Technology Co., Ltd. (hereinafter referred to as "Hingin Technology"). LaserPecker is a registered trademark of Hingin Technology.
- The information in this manual may be changed without notice; The information in this manual does not constitute a commitment of the Company. Please learn about the latest update from (<https://www.laserpecker.net>). The contents of this manual shall not be rewritten or forwarded in any form or for any purpose without the written permission of the Company.

**LaserPecker**