



Air Purifier

User Manual | Manuel d'utilisation | Manual de Usuario | Benutzerhandbuch

ユーザーマニュアル | 사용 설명서 | 使用説明書 | 使用说明书



www.laserpecker.net

Disclamier

- Please ensure that anyone using this product reads and understands this manual before operation.
- Failure to follow this manual may result in personal injury, poor quality of the finished work, or damage to the product, for which LaserPecker shall not be held responsible.
- This manual is for reference only. LaserPecker provides no express or implied warranty or liability for the accuracy, completeness, or timeliness of the information provided.
- Users are responsible for the installation, transportation, storage, application, repair, and management of the product. LaserPecker shall not be liable for any personal injury, property damage, or product damage that may arise.
- When using LaserPecker products, users are obliged to observe intellectual property rights and applicable laws and regulations.

Purpose of Use

- The LaserPecker Air Purifier is designed to provide processed clean air by capturing, collecting, and removing suspended particles and fumes.
- Paired with a vacuuming accessory, it assists in dust removal to keep your workspace surface clean.

Safety Instructions

- Use the Air Purifier with a LaserPecker laser's protection cover.
- Turn the Air Purifier off immediately if abnormal noise, smell, sparks, or flame occur inside or near the product, the cover, or the machine.
- Immediately stop using the Air Purifier if there is damaged to it internally or externally, or to the air ducts, or the connecting cables.
- Do NOT place any liquid, food, metal, or flammable material onto the Air Purifier.
- Do NOT block the air inlet or outlet.
- Do NOT keep the Air Purifier in a wet or damp environment.
- Do NOT use the Air Purifier on an unstable or uneven surface or worktable. Always keep the Air Purifier in an upright position.
- Do NOT over twist/bend the connecting cable and do not place it under a carppet or near a source of heat.

Technical Specifications

Dimensions	247 x 268 x 265 mm
Filter set dimensions	190 x 198 x 165 mm
Air duct size	60 mm diameter, 1.5 m length
Weight	6.2 kg
Filter set weight	1.5 kg
Filter set lifespan	3-6 months
Fan adapter diameter	52 mm
Air inlet and outlet diameter	73 mm
Maximum noise level	50-67 dB
Power cord length	2 m
Nominal current	2.5 A
Input voltage	24 V
Nominal power	60 W
Operating temperature	0 °C - 35 °C
Storage temperature	-4 °C - 45 °C

What's in the box



Air Purifier x 1

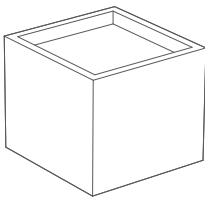

Filter Set x 1

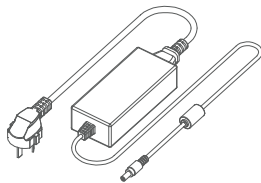

Power Adapter x 1

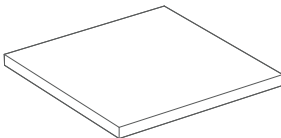

Cotton Pre-Filter x 2

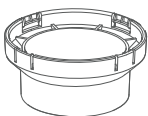

Fan Adapter x 1

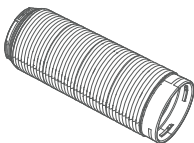

Air Inlet Duct (1.5 m) x 1

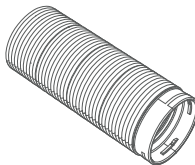

Air Outlet Duct (1.5 m) x 1



User Manual x 1

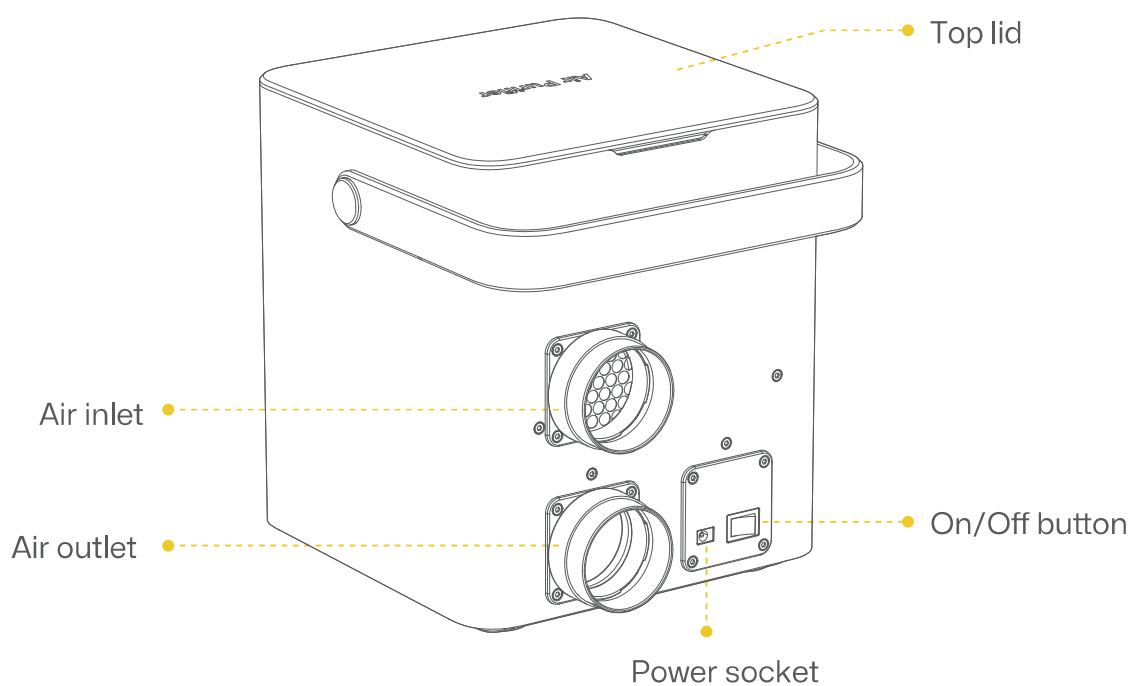
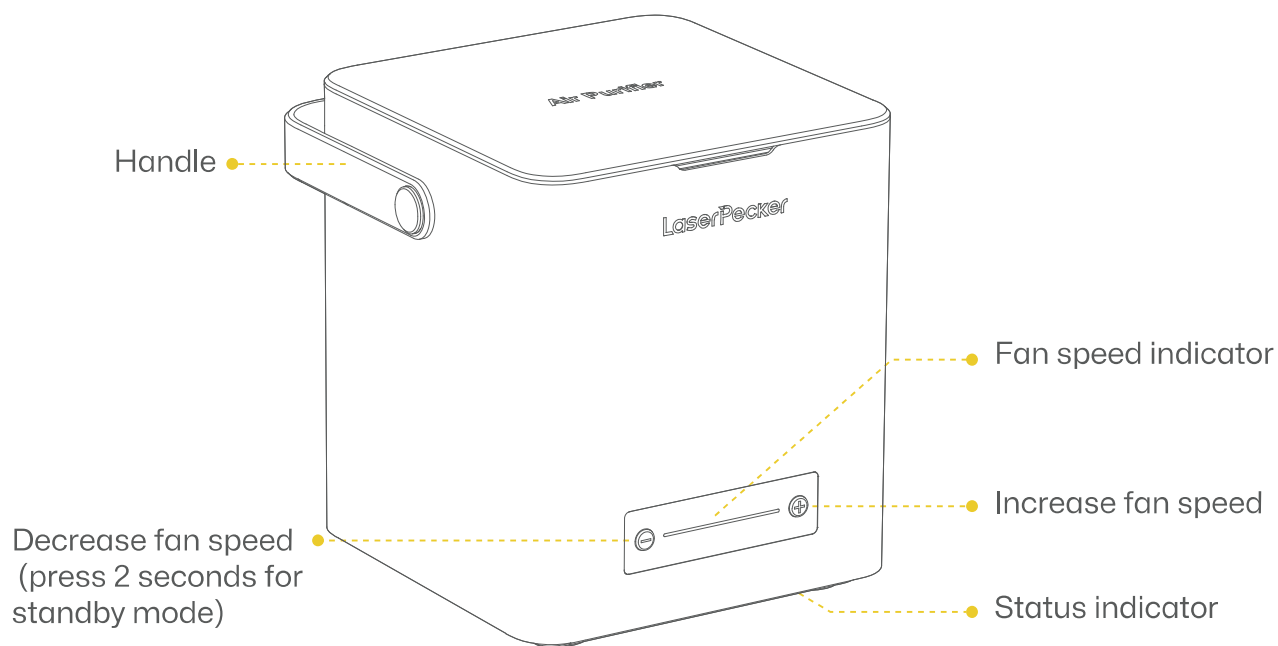

Installing Filter Set

Before first use, remove the moisture-proof film on the filter set before putting it into the Air Purifier. Align the arrow and close the top lid to ensure that there are no gaps.

Installing Air Ducts

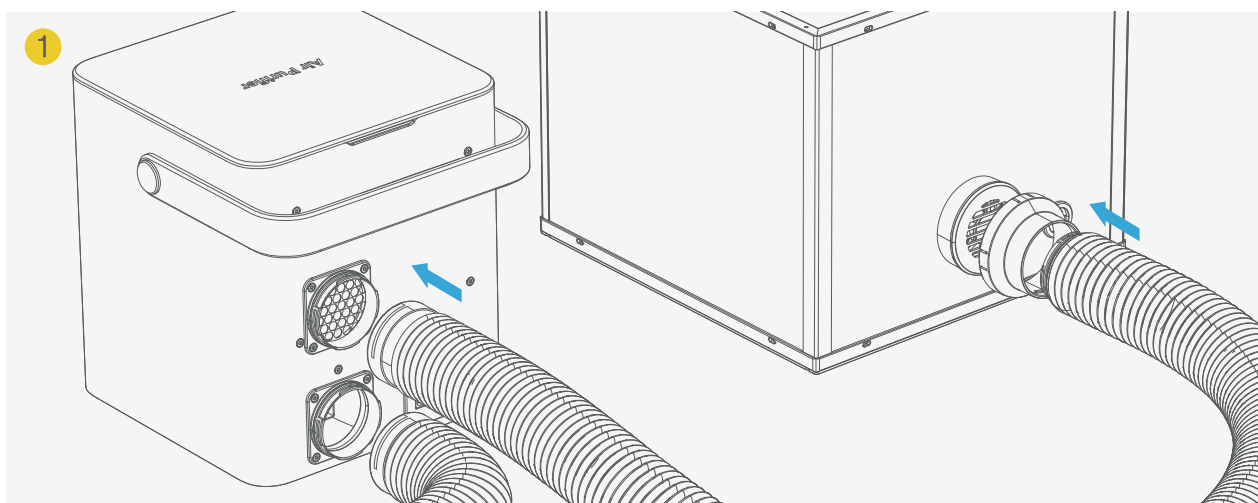

1. Connect the air inlet duct to the air inlet (the upper port on the air purifier). Connect the other end with the fan adapter to the protection cover's exhaust outlet.

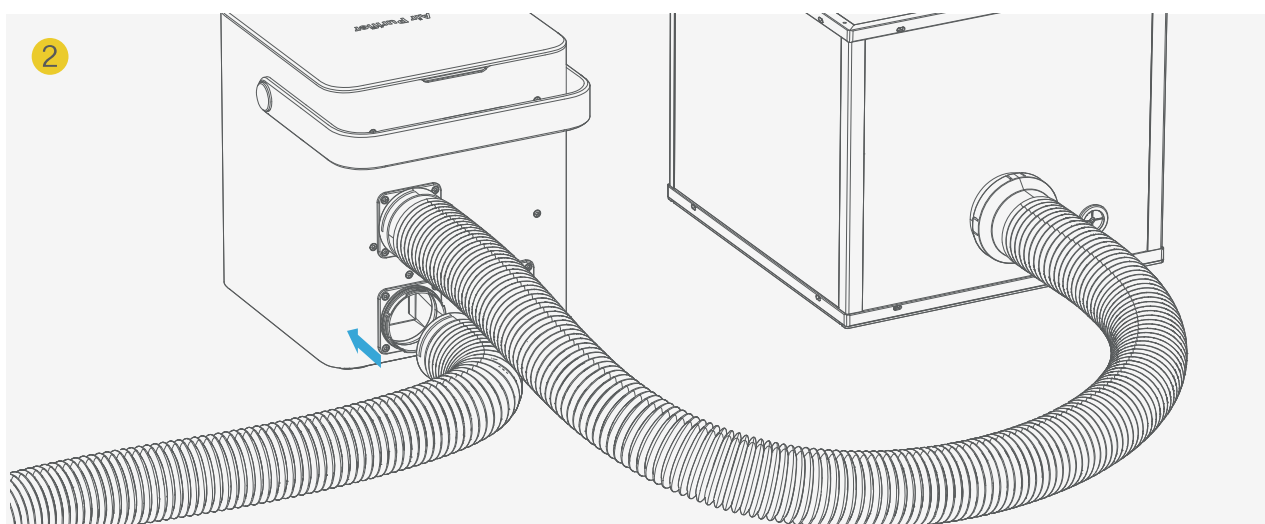

2. Connect the air outlet duct to the air outlet (the lower port on the air purifier). When working indoors, place the other open end of the exhaust hose outside a window.

Connecting to Power

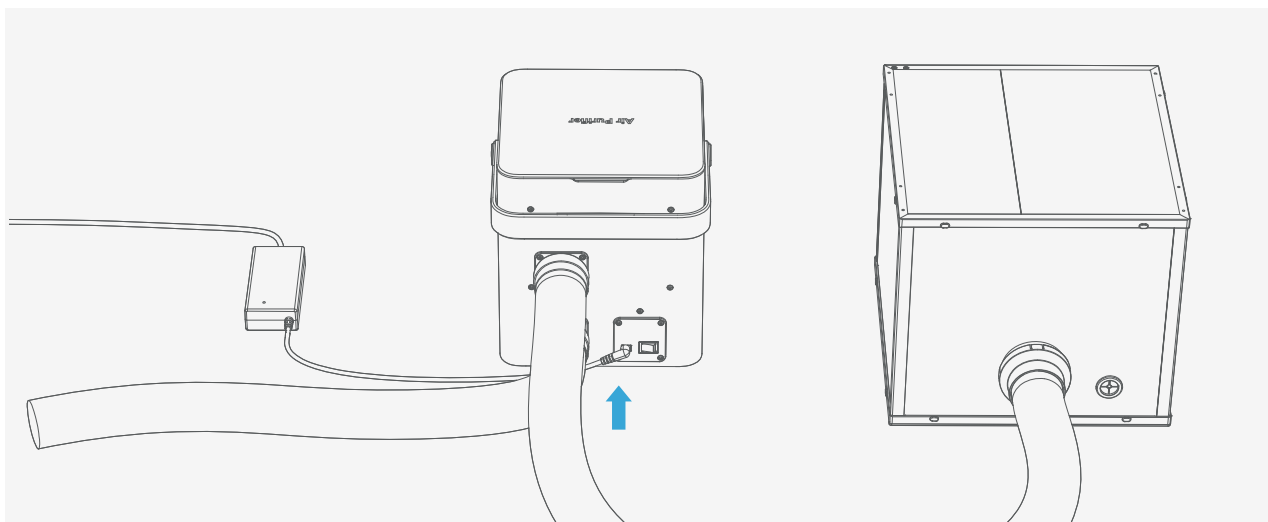

Connect the power adapter to the power socket.

Checking the Assembly

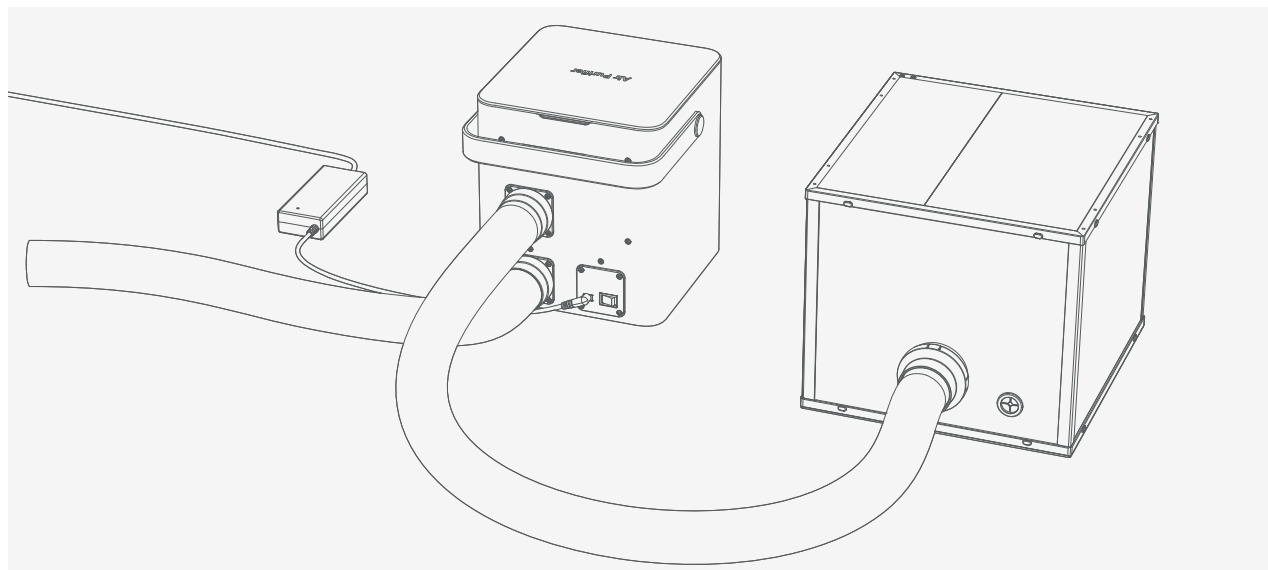

Ensure that the machine, protection cover, and air purifier are correctly assembled and connected as depicted below.

Precautions

Before powering on the LaserPecker Air Purifier for the first time, please check the assembly to ensure a safe and stable operation.

- Check for any physical damage to the Air Purifier's appearance;
- Check if the filter set is properly installed;
- Check if the top lid is correctly positioned and securely in place.

Operation

1. Turn on the power switch on the back of the air purifier.
2. Click any button on the front panel to activate it.
3. Increase or decrease the fan speed using the "+" and "-" buttons.
4. For standby mode, press the "-" button for 2 seconds.

Reading Status

The LaserPecker Air Purifier is equipped with an intelligent detection function. It will remind you to replace the filter set, alert you in the event of a missing filter set or malfunction by changing the indicator colors.



No Visible Light

- The Air Purifier is not connected.
- Power failure.
- The power switch is off.



Flashing Red Light (Danger)

- The fan is not running.
- The power adapter is not compatible.
- Internal parts are damaged.
- The top lid is not in place.



Orange Light

- The filter set shall be replaced.



Flashing Orange Light

- The filter set is not installed properly.



Solid Blue Light

- Normal operation.

The filter set provides a 4 layer filtration, combining the cotton pre-filter, H13 grade HEPA filters, and the activated carbon filter. It captures large airborne particles, dust, smoke as well as other ultrafine particles down to 0.3µm.

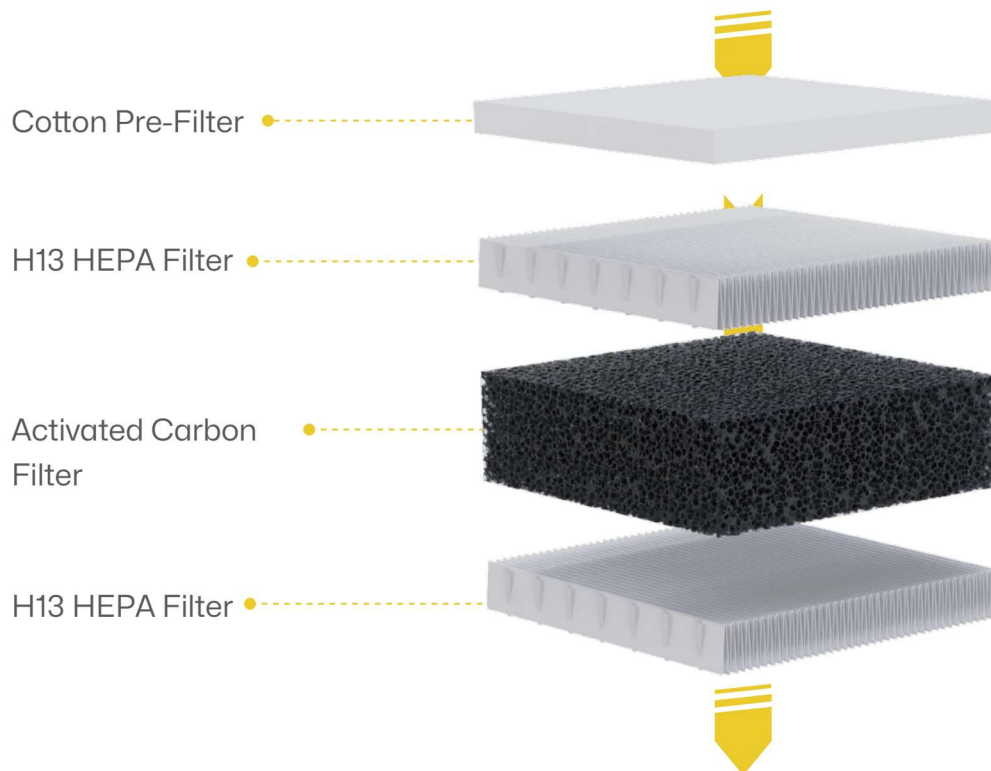

Filter Lifespan

- The filter set's lifespan is monitored by calculating the Air Purifier's cumulative operating hours. When reaching the predetermined time (600 hours), the orange light will illuminate, indicating the service lifespan has been reached and reminding you to replace the filter set.
- Replace visibly blackened and/or clogged Cotton Pre-Filter for the best filtration results.
- The actual lifespan of the filter set may vary depending on factors such as usage time and intensity.
- Discontinue using the filter set if there is any damage to its appearance or if particles are leaking out.
- It is recommended to replace the entire filter set after replacing cotton pre-filters three times.
- For optimal efficiency, it is recommended to use official filter sets without adding any additional filter layers to the existing filter set.
- Do NOT clean the filter set.

Replacing the Filter

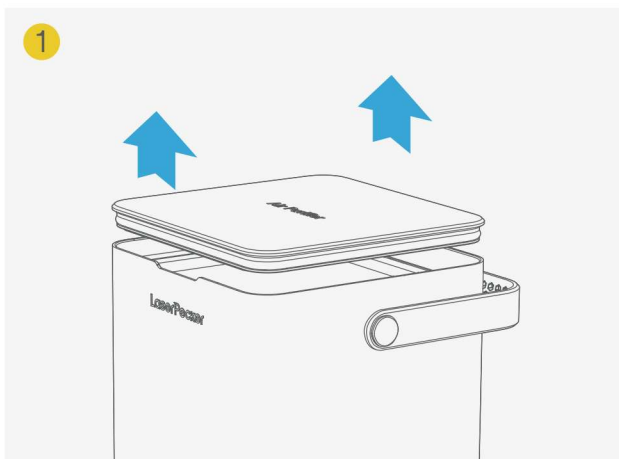

Turn off the power and remove the top lid.

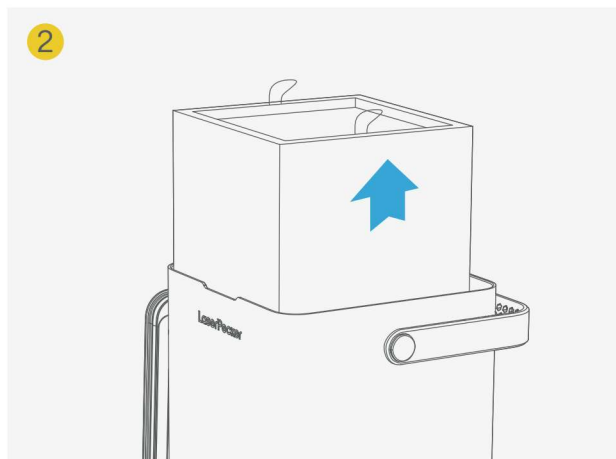

Use the black loops to lift and remove the old filter set.

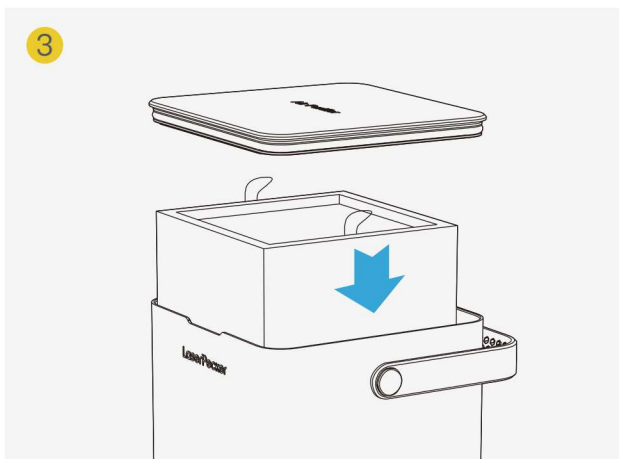

Insert the new filter set so the loops are positioned on the sides and close the lid.

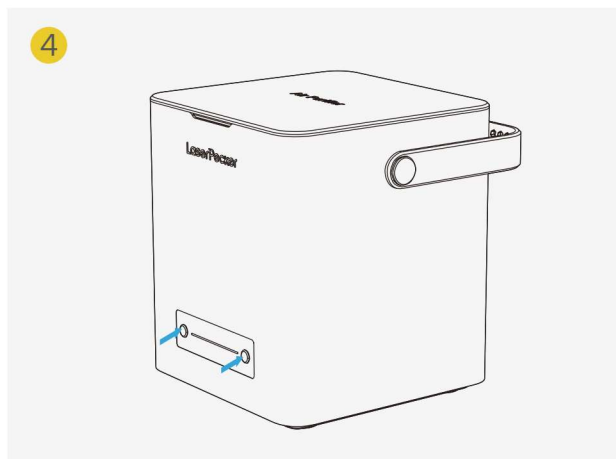

Turn the power on and simultaneously press the '+' and '-' buttons for 2 seconds. When the indicator light turns from orange to blue, the filter replacement is completed.

After-sales Information

If you encounter any issues, please do not hesitate to reach out to our customer support team.

✉ support@laserpecker.com

